

AUTOMATIC TUBE WELD FITTINGS



SANKO KOGYO CO., LTD.

<http://www.jsk-sanko.co.jp>



AUTOMATIC TUBE WELD FITTINGS

Components are ordered by product code as listed in this catalogue

DESIGNATIONS PART NUMBER SYSTEM

| | | | | |
|----------|----------|----------|----------|-----------|
| M | E | 4 | S | EP |
| ① | ② | ③ | ④ | ⑤ |

| | | |
|----------|---|---------------------------|
| ① Series | M | Micro Fitting L=6.35 mm |
| | S | Short Fitting L=10 mm |
| | L | Forged Fitting L=19.05 mm |

| | | |
|-----------|----|---------|
| ② Product | E | Elbow |
| | T | Tee |
| | CT | Cross |
| | TB | Tribow |
| | R | Reducer |

| | | |
|--------|----|---------|
| ③ Size | 2 | 1/8" OD |
| | 4 | 1/4" OD |
| | 6 | 3/8" OD |
| | 8 | 1/2" OD |
| | 12 | 3/4" OD |
| | 16 | 1" OD |

| | | |
|------------|---|-----------------------|
| ④ Material | S | Single Melt (316L) |
| | V | Double Melt (VIM+VAR) |

| | | |
|-------------|----|------------|
| ⑤ Finishing | BA | Ry < 3.0μm |
| | EP | Ry < 0.7μm |



CONTENTS

MICRO WELD FITTINGS

MR

Micro Reducer
Pages 20



ME

Micor Reducing 90° Elbow
Pages 20



ME

Micro 90° Elbow
Pages 20



MEL

Micro Extended Leg 90°
Elbow
Pages 20



MEF

Micro 45° Elbow
Pages 20



MT

Micro Tee
Pages 21



MT

Micro Reducing Tee
Pages 21



MCT

Micro Cross
Pages 21



MTB

Micro Tribow
Pages 21



LR,SR

Reducer
Pages 23



FORGED WELD FITTINGS

LE,SE

90° Elbow
Pages 22



LE

Reducing 90°
Elbow
Pages 22



LT,ST

Tee
Pages 22



LT,ST

Reducing Tee
Pages 22



LCT,SCT

Cross
Pages 23



AUTO
TUBE
WELD
Fittings



AUTOMATIC TUBE WELD FITTINGS



■ Features

- 316L VIM/VAR material.
- Permanently heat code marked; traceable to original mill certificated of test.
- Electropolished components permanently marked with designator on cube (P or PX)
- Critical surfaces are 100% visually inspected using magnification and lighting.

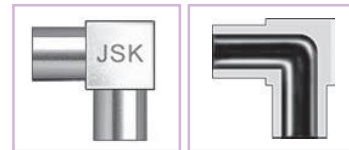

■ Materials

- 316 VIM/VAR materials comply with ASTM A267 and ASME SA479. Recommended tubing specifications will be including ASME SA213, ASTM A213, ASTM A249, ASTM A269, MIL T8506 and JIS G4303.

■ Specifications

- Pressure Ratings will be governed by the tubing selected for a particular application. Working Pressures are calculated below for tubing using maximum allowable stress levels in accordance with ASME/ANSI B31.3, at ambient temperature.
- Dimensions are for reference only and are subjected to change.
- Internal Surface Finishes: Standard Finish Micro Fittings have an internal Surface Roughness of 3.0µm Ry. Electropolished Micro Fittings have an internal Surface Roughness of 0.7µm Ry.

| Tube O.D. | Pressure Rating | | Normal Wall Thickness mm |
|-----------|-----------------|---------------------|--------------------------|
| | psig | kgf/cm ² | |
| 1/4"OD | 5100 | 358 | 1.0 (0.89) |
| 3/8"OD | 3300 | 232 | 1.0 (0.89) |
| 1/2"OD | 3500 | 246 | 1.24mm |
| 3/4"OD | 2400 | 160 | 1.65mm |

Optional: 1/4"OD Wall Thickness 0.89mm

| Designator | Surface Finish(Ry) |
|------------|--------------------|
| | Maximum |
| EP | 0.7 µm |
| BA | 3.0 µm |



MICRO WELD FITTINGS

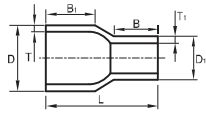

□: BA or EP

Micro Reducer (MR)

| Size (OD) | Size (OD ₁) | Ordering Number | D | D ₁ | T | T ₁ | B | B ₁ | L |
|-----------|-------------------------|-----------------|-------|----------------|------|----------------|------|----------------|------|
| 3/8" | 1/4" | MR64S□ | 9.53 | 6.35 | 1.00 | 1.00 | 6.35 | 10.4 | 19.1 |
| 1/2" | 1/4" | MR84S□ | 12.70 | 6.35 | 1.24 | 1.00 | 6.35 | 10.4 | 19.1 |
| 1/2" | 3/8" | MR86S□ | 12.70 | 9.53 | 1.24 | 1.00 | 6.35 | 10.4 | 19.1 |
| 3/4" | 1/4" | MR124S□ | 19.05 | 6.35 | 1.65 | 1.00 | 6.35 | 10.4 | 19.1 |
| 3/4" | 3/8" | MR126S□ | 19.05 | 9.53 | 1.65 | 1.00 | 6.35 | 10.4 | 19.1 |
| 3/4" | 1/2" | MR128S□ | 19.05 | 12.70 | 1.65 | 1.24 | 6.35 | 10.4 | 19.1 |

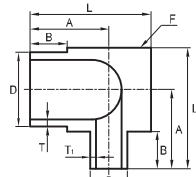

Micro Reducing 90° Elbow (ME)

| Size (OD) | Size (OD ₁) | Ordering Number | D | D ₁ | T | T ₁ | A | B | F Body Cube | L |
|-----------|-------------------------|-----------------|-------|----------------|------|----------------|-------|------|-------------|-------|
| 3/8" | 1/4" | ME64S□ | 9.53 | 6.35 | 1.00 | 1.00 | 11.91 | 6.35 | 11.11 | 17.46 |
| 1/2" | 1/4" | ME84S□ | 12.70 | 6.35 | 1.24 | 1.00 | 13.50 | 6.35 | 14.29 | 20.64 |
| 1/2" | 3/8" | ME86S□ | 12.70 | 9.53 | 1.24 | 1.00 | 13.50 | 6.35 | 14.29 | 20.64 |
| 3/4" | 1/4" | ME124S□ | 19.05 | 6.35 | 1.65 | 1.00 | 16.68 | 6.35 | 20.65 | 27.00 |
| 3/4" | 3/8" | ME126S□ | 19.05 | 9.53 | 1.65 | 1.00 | 16.68 | 6.35 | 20.65 | 27.00 |
| 3/4" | 1/2" | ME128S□ | 19.05 | 12.70 | 1.65 | 1.24 | 16.68 | 6.35 | 20.65 | 27.00 |

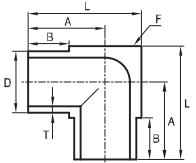

Micro 90° Elbow (ME)

| Size (OD) | Ordering Number | D | T | A | B | F Body Cube | L |
|-----------|-----------------|-------|------|-------|------|-------------|-------|
| 1/4" | ME4S□ | 6.35 | 1.00 | 10.32 | 6.35 | 7.94 | 14.29 |
| 3/8" | ME6S□ | 9.53 | 1.00 | 11.91 | 6.35 | 11.11 | 17.46 |
| 1/2" | ME8S□ | 12.70 | 1.24 | 13.50 | 6.35 | 14.29 | 20.64 |
| 3/4" | ME12S□ | 19.05 | 1.65 | 16.68 | 6.35 | 20.65 | 27.00 |

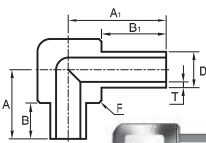

Micro Extended Leg 90° Elbow (MEL)

| Size (OD) | Ordering Number | D | T | A | A ₁ | B | B ₁ | F Body Cube |
|-----------|-----------------|------|------|-------|----------------|------|----------------|-------------|
| 1/4" | MEL4S□ | 6.35 | 1.00 | 12.30 | 17.38 | 6.35 | 11.43 | 11.11 |

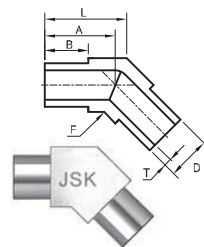

Micro 45° Elbow (MEF)

| Size (OD) | Ordering Number | D | T | A | B | F Body Cube | L |
|-----------|-----------------|-------|------|-------|------|-------------|-------|
| 1/4" | MEF4S□ | 6.35 | 1.00 | 10.32 | 6.35 | 7.94 | 11.96 |
| 3/8" | MEF6S□ | 9.53 | 1.00 | 11.91 | 6.35 | 11.11 | 14.21 |
| 1/2" | MEF8S□ | 12.70 | 1.24 | 13.50 | 6.35 | 14.29 | 16.46 |
| 3/4" | MEF12S□ | 19.05 | 1.65 | 16.68 | 6.35 | 20.65 | 20.95 |

* Dimensions are in millimeters unless specified as * inch*

AUTO
TUBE
WELD
Fittings



MICRO WELD FITTINGS

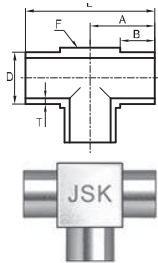

□: BA or EP

Micro Tee (MT)

| Size (OD) | Ordering Number | D | T | A | B | F Body Cube | L |
|-----------|-----------------|-------|------|-------|------|-------------|-------|
| 1/4" | MT4S□ | 6.35 | 1.00 | 10.32 | 6.35 | 7.94 | 20.64 |
| 3/8" | MT6S□ | 9.53 | 1.00 | 11.91 | 6.35 | 11.11 | 23.81 |
| 1/2" | MT8S□ | 12.70 | 1.24 | 13.50 | 6.35 | 14.29 | 26.99 |
| 3/4" | MT12S□ | 19.05 | 1.65 | 16.68 | 6.35 | 20.65 | 33.35 |

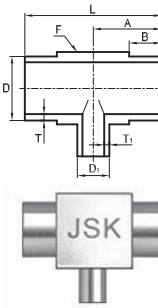

Micro Reducing Tee (MT)

| Size (OD) | Size (OD ₁) | Ordering Number | D | D ₁ | T | T ₁ | A | B | F Body Cube | L |
|-----------|-------------------------|-----------------|-------|----------------|------|----------------|-------|------|-------------|-------|
| 3/8" | 1/4" | MT64S□ | 9.53 | 6.35 | 1.00 | 1.00 | 11.91 | 6.35 | 11.11 | 23.81 |
| 1/2" | 1/4" | MT84S□ | 12.70 | 6.35 | 1.24 | 1.00 | 13.50 | 6.35 | 14.29 | 26.99 |
| 1/2" | 3/8" | MT86S□ | 12.70 | 9.53 | 1.24 | 1.00 | 13.50 | 6.35 | 14.29 | 26.99 |
| 3/4" | 1/4" | MT124S□ | 19.05 | 6.35 | 1.65 | 1.00 | 16.68 | 6.35 | 20.65 | 27.00 |
| 3/4" | 3/8" | MT126S□ | 19.05 | 9.53 | 1.65 | 1.00 | 16.68 | 6.35 | 20.65 | 27.00 |
| 3/4" | 1/2" | MT128S□ | 19.05 | 12.70 | 1.65 | 1.24 | 16.68 | 6.35 | 20.65 | 27.00 |

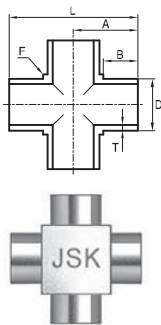

Micro Cross (MCT)

| Size (OD) | Ordering Number | D | T | A | B | F Body Cube | L |
|-----------|-----------------|-------|------|-------|------|-------------|-------|
| 1/4" | MCT4S□ | 6.35 | 1.00 | 10.32 | 6.35 | 7.94 | 20.64 |
| 3/8" | MCT6S□ | 9.53 | 1.00 | 11.91 | 6.35 | 11.11 | 23.81 |
| 1/2" | MCT8S□ | 12.70 | 1.24 | 13.50 | 6.35 | 14.29 | 26.99 |
| 3/4" | MCT12S□ | 19.05 | 1.65 | 16.68 | 6.35 | 20.65 | 33.35 |

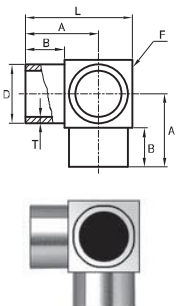

Micro Tribow (MTB)

| Size (OD) | Ordering Number | D | T | A | B | F Body Cube | L |
|-----------|-----------------|-------|------|-------|------|-------------|-------|
| 1/4" | MTB4S□ | 6.35 | 1.00 | 10.32 | 6.35 | 7.94 | 14.29 |
| 3/8" | MTB6S□ | 9.53 | 1.00 | 11.91 | 6.35 | 11.11 | 17.46 |
| 1/2" | MTB8S□ | 12.70 | 1.24 | 13.50 | 6.35 | 14.29 | 20.64 |
| 3/4" | MTB12S□ | 19.05 | 1.65 | 16.68 | 6.35 | 20.65 | 27.00 |

• Dimensions are in millimeters unless specified as "inch"



FORGED WELD FITTINGS

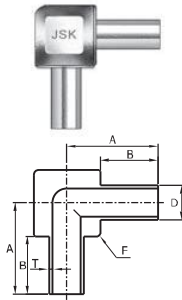

□: BA or EP

90° Elbow (LE,SE)

| Size (OD) | Ordering Number | D | T | A | B | F Body Cube |
|-----------|-----------------|-------|------|------|-------|-------------|
| 1/4" | LE4S□ | 6.35 | 1.00 | 25.0 | 19.05 | 11.2 |
| 3/8" | LE6S□ | 9.53 | 1.00 | 25.0 | 19.05 | 11.2 |
| 1/2" | LE8S□ | 12.70 | 1.24 | 29.0 | 19.05 | 17.5 |
| 3/4" | LE12S□ | 19.05 | 1.65 | 35.8 | 23.30 | 25.0 |
| 1" | LE16S□ | 25.40 | 1.65 | 38.3 | 23.30 | 30.0 |
| 1/4" | SE4S□ | 6.35 | 1.00 | 15.9 | 10.00 | 11.2 |
| 3/8" | SE6S□ | 9.53 | 1.00 | 15.9 | 10.00 | 11.2 |
| 1/2" | SE8S□ | 12.70 | 1.24 | 19.9 | 10.00 | 17.5 |
| 3/4" | SE12S□ | 19.05 | 1.65 | 22.4 | 10.00 | 25.0 |

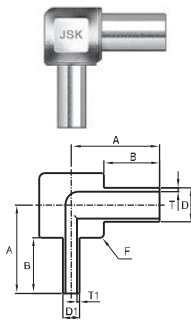

Reducing 90° Elbow (LE)

| Size (OD) | Size (OD ₁) | Ordering Number | D | D ₁ | T | T ₁ | B | A | F Body Cube |
|-----------|-------------------------|-----------------|-------|----------------|------|----------------|-------|-------|-------------|
| 3/8" | 1/4" | LE64S□ | 9.53 | 6.35 | 1.00 | 1.00 | 19.05 | 25 | 11.2 |
| 1/2" | 1/4" | LE84S□ | 12.70 | 6.35 | 1.24 | 1.00 | 19.05 | 29 | 17.5 |
| 1/2" | 3/8" | LE86S□ | 12.70 | 9.53 | 1.24 | 1.00 | 19.05 | 29 | 17.5 |
| 3/4" | 1/4" | LE124S□ | 19.05 | 6.35 | 1.65 | 1.00 | 23.30 | 35.80 | 25.0 |
| 3/4" | 3/8" | LE126S□ | 19.05 | 9.52 | 1.65 | 1.00 | 23.30 | 35.80 | 25.0 |
| 3/4" | 1/2" | LE128S□ | 19.05 | 12.70 | 1.65 | 1.24 | 23.30 | 35.80 | 25.0 |
| 1" | 1/4" | LE164S□ | 25.40 | 6.35 | 1.65 | 1.00 | 23.30 | 38.30 | 30.0 |
| 1" | 3/8" | LE166S□ | 25.40 | 9.52 | 1.65 | 1.00 | 23.30 | 38.30 | 30.0 |
| 1" | 1/2" | LE168S□ | 25.40 | 12.70 | 1.65 | 1.24 | 23.30 | 38.30 | 30.0 |
| 1" | 3/4" | LE1612S□ | 25.40 | 19.05 | 1.65 | 1.65 | 23.30 | 38.30 | 30.0 |

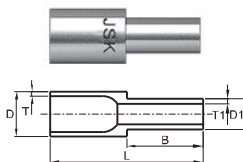

Reducer (LR,SR)

| Size (OD) | Size (OD ₁) | Ordering Number | D | D ₁ | T | T ₁ | B | L |
|-----------|-------------------------|-----------------|-------|----------------|------|----------------|-------|-------|
| 3/8" | 1/4" | LR64S□ | 9.53 | 6.35 | 1.00 | 1.00 | 19.05 | 38.10 |
| 1/2" | 1/4" | LR84S□ | 12.70 | 6.35 | 1.24 | 1.00 | 19.05 | 38.10 |
| 1/2" | 3/8" | LR86S□ | 12.70 | 9.53 | 1.24 | 1.00 | 19.05 | 38.10 |
| 3/4" | 1/4" | LR124S□ | 19.05 | 6.35 | 1.65 | 1.00 | 19.05 | 42.90 |
| 3/4" | 3/8" | LR126S□ | 19.05 | 9.53 | 1.65 | 1.00 | 19.05 | 42.90 |
| 3/4" | 1/2" | LR128S□ | 19.05 | 12.70 | 1.65 | 1.24 | 19.05 | 42.90 |
| 1" | 1/4" | LR164S□ | 25.40 | 6.35 | 1.65 | 1.00 | 19.05 | 42.90 |
| 1" | 3/8" | LR166S□ | 25.40 | 9.52 | 1.65 | 1.00 | 19.05 | 42.90 |
| 1" | 1/2" | LR168S□ | 25.40 | 12.70 | 1.65 | 1.24 | 19.05 | 42.90 |
| 1" | 3/4" | LR1612S□ | 25.40 | 19.05 | 1.65 | 1.65 | 23.30 | 47.15 |
| 3/8" | 1/4" | SR64S□ | 9.53 | 6.35 | 1.00 | 1.00 | 10.00 | 20.0 |
| 1/2" | 1/4" | SR84S□ | 12.70 | 6.35 | 1.24 | 1.00 | 10.00 | 20.0 |
| 1/2" | 3/8" | SR86S□ | 12.70 | 9.53 | 1.24 | 1.00 | 10.00 | 20.0 |
| 3/4" | 1/4" | SR124S□ | 19.05 | 6.35 | 1.65 | 1.00 | 10.00 | 20.0 |
| 3/4" | 3/8" | SR126S□ | 19.05 | 9.53 | 1.65 | 1.00 | 10.00 | 20.0 |
| 3/4" | 1/2" | SR128S□ | 19.05 | 12.70 | 1.65 | 1.24 | 10.00 | 20.0 |

* Dimensions are in millimeters unless specified as * inch*

AUTO TUBE WELD Fittings



FORGED WELD FITTINGS

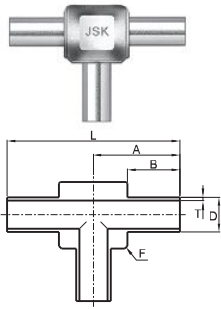

| Tee (LT,ST) | | | | | | | |
|-------------|-----------------|-------|------|------|-------|-------------|------|
| Size (OD) | Ordering Number | D | T | A | B | F Body Cube | L |
| 1/4" | LT4S□ | 6.35 | 1.00 | 25.0 | 19.05 | 11.2 | 50.0 |
| 3/8" | LT6S□ | 9.53 | 1.00 | 25.0 | 19.05 | 11.2 | 50.0 |
| 1/2" | LT8S□ | 12.70 | 1.24 | 29.0 | 19.05 | 17.5 | 58.0 |
| 3/4" | LT12S□ | 19.05 | 1.65 | 35.8 | 23.30 | 25.0 | 71.6 |
| 1" | LT16S□ | 25.40 | 1.65 | 38.3 | 23.30 | 30.0 | 76.6 |
| 1/4" | ST4S□ | 6.35 | 1.00 | 15.9 | 10.00 | 11.2 | 31.8 |
| 3/8" | ST6S□ | 9.53 | 1.00 | 15.9 | 10.00 | 11.2 | 31.8 |
| 1/2" | ST8S□ | 12.70 | 1.24 | 19.9 | 10.00 | 17.5 | 39.8 |
| 3/4" | ST12S□ | 19.05 | 1.65 | 22.4 | 10.00 | 25.0 | 44.8 |

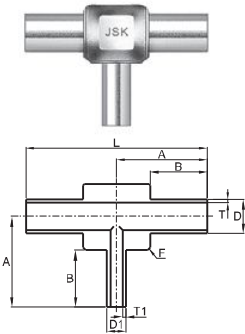

| Reducing Tee (LT,ST) | | | | | | | | | | |
|----------------------|-------------------------|-----------------|-------|----------------|------|----------------|------|-------|-------------|------|
| Size (OD) | Size (OD ₁) | Ordering Number | D | D ₁ | T | T ₁ | A | B | F Body Cube | L |
| 3/8" | 1/4" | LT64S□ | 9.53 | 6.35 | 1.00 | 1.00 | 25.0 | 19.05 | 11.2 | 50.0 |
| 1/2" | 1/4" | LT84S□ | 12.70 | 6.35 | 1.24 | 1.00 | 29.0 | 19.05 | 17.5 | 58.0 |
| 1/2" | 3/8" | LT86S□ | 12.70 | 9.53 | 1.24 | 1.00 | 29.0 | 19.05 | 17.5 | 58.0 |
| 3/4" | 1/4" | LT124S□ | 19.05 | 6.35 | 1.65 | 1.00 | 35.8 | 23.30 | 25.0 | 71.6 |
| 3/4" | 3/8" | LT126S□ | 19.05 | 9.53 | 1.65 | 1.00 | 35.8 | 23.30 | 25.0 | 71.6 |
| 3/4" | 1/2" | LT128S□ | 19.05 | 12.70 | 1.65 | 1.24 | 35.8 | 23.30 | 25.0 | 71.6 |
| 1" | 1/4" | LT164S□ | 25.40 | 6.35 | 1.65 | 1.00 | 38.3 | 23.30 | 30.0 | 76.6 |
| 1" | 3/8" | LT166S□ | 25.40 | 9.52 | 1.65 | 1.00 | 38.3 | 23.30 | 30.0 | 76.6 |
| 1" | 1/2" | LT168S□ | 25.40 | 12.70 | 1.65 | 1.24 | 38.3 | 23.30 | 30.0 | 76.6 |
| 1" | 3/4" | LT1612S□ | 25.40 | 19.05 | 1.65 | 1.65 | 38.3 | 23.30 | 30.0 | 76.6 |
| 3/8" | 1/4" | ST64S□ | 9.53 | 6.35 | 1.00 | 1.00 | 15.9 | 10.00 | 11.2 | 31.8 |
| 1/2" | 1/4" | ST84S□ | 12.70 | 6.35 | 1.24 | 1.00 | 19.9 | 10.00 | 17.5 | 39.8 |
| 1/2" | 3/8" | ST86S□ | 12.70 | 9.53 | 1.24 | 1.00 | 19.9 | 10.00 | 17.5 | 39.8 |
| 3/4" | 1/4" | ST124S□ | 19.05 | 6.35 | 1.65 | 1.00 | 22.4 | 10.00 | 25.0 | 44.8 |
| 3/4" | 3/8" | ST126S□ | 19.05 | 9.53 | 1.65 | 1.00 | 22.4 | 10.00 | 25.0 | 44.8 |
| 3/4" | 1/2" | ST128S□ | 19.05 | 12.70 | 1.65 | 1.24 | 22.4 | 10.00 | 25.0 | 44.8 |

□: BA or EP

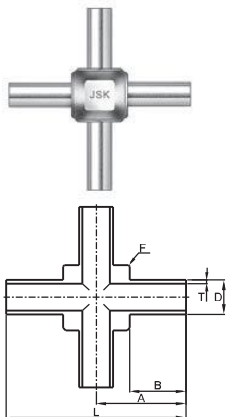

| Tee (LCT, SCT) | | | | | | | |
|----------------|-----------------|-------|------|------|-------|-------------|------|
| Size (OD) | Ordering Number | D | T | A | B | F Body Cube | L |
| 1/4" | LCT4S□ | 6.35 | 1.00 | 25.0 | 19.05 | 11.2 | 50.0 |
| 3/8" | LCT6S□ | 9.53 | 1.00 | 25.0 | 19.05 | 11.2 | 50.0 |
| 1/2" | LCT8S□ | 12.70 | 1.24 | 29.0 | 19.05 | 17.5 | 58.0 |
| 3/4" | LCT12S□ | 19.05 | 1.65 | 35.8 | 23.30 | 25.0 | 71.6 |
| 1/4" | SCT4S□ | 6.35 | 1.00 | 15.9 | 10.00 | 11.2 | 31.8 |
| 3/8" | SCT6S□ | 9.53 | 1.00 | 15.9 | 10.00 | 11.2 | 31.8 |
| 1/2" | SCT8S□ | 12.70 | 1.24 | 19.9 | 10.00 | 17.5 | 39.8 |
| 3/4" | SCT12S□ | 19.05 | 1.65 | 22.4 | 10.00 | 25.0 | 44.8 |

• Dimensions are for reference only and are subject to change.

• Dimensions are in millimeters unless specified as "inch"